

**MONDIAL**

**M23 F P21.14**  
**M33 F P37.14**

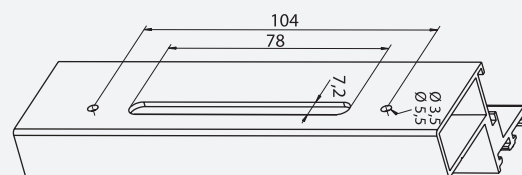

**CREMONE PARA FACHADAS**  
CREMONE FOR CURTAIN WALL  
CREMONA PARA MURO DE CORTINA  
CREMONE FOUR FAÇADE

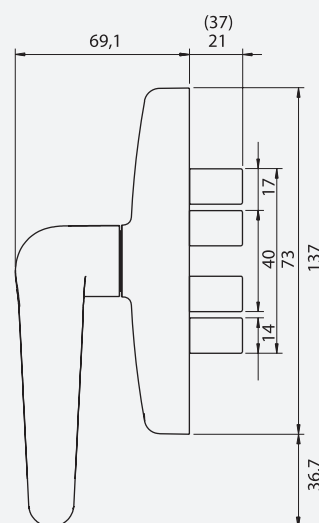
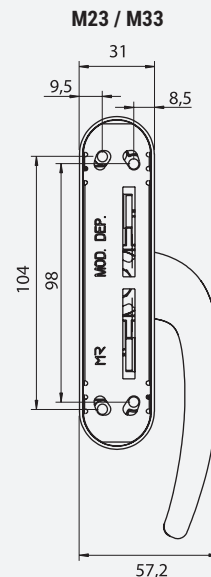

**EMBALAGEM - PACKAGING**  
**EMPAQUETADO - EMBALLAGE**

**12 unidades por caixa**  
12 pieces per box  
12 unidades por caja  
12 pieces par boîte

**MATERIAIS - MATERIALS**  
**MATERIALES - MATERIAUX**

**Alumínio - Zamak - Inox**  
Aluminium - Zamak - Stainless steel  
Aluminio - Zamak - Acero inox  
Aluminium - Zamak - Inox

**FIXAÇÃO - FIXING**  
**FIJACIÓN - FIXATION**

**Parafusos incluídos**  
Screws included  
Tornillos incluidos  
Vis inclus

**ACABAMENTO - FINISHING**  
**ACABADOS - FINITION**

**Lacado**  
Powder painting  
Lacado  
Laqué

**NORMA - STANDARD**  
**NORMA - NORME**

EN 1670  
EN 13126

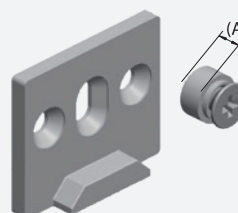

**PONTO DE FECHO · CLOSED POINT**  
**PUNTO DE CIELO · POINT FERMÉ**

REF. <sup>a</sup>	Tam. (A)
<b>33532</b>	8,5 mm
<b>33533</b>	6,5 mm
	10,5 mm